

FIXING CHOKE CABLE

Follow the steps below to fix the choke cable on Westinghouse inverter generators for proper operation.

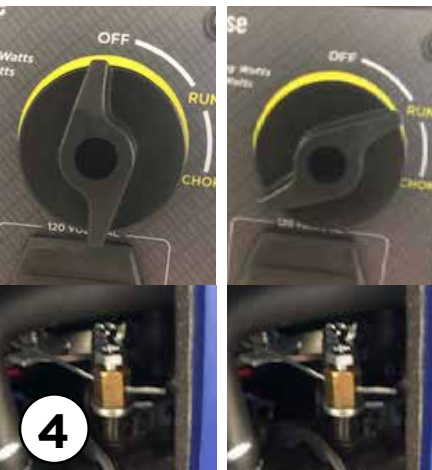

1. Make sure the engine is “off” and the generator is cold.
2. Remove the 2 screws that secure the engine maintenance panel to the frame. Slide off the spark access cover and push out on panel to remove.
3. Locate the choke cable.
4. Switch the engine control switch from OFF to RUN while observing the choke cable. If the choke moves from OFF to RUN you will need to adjust the cable.

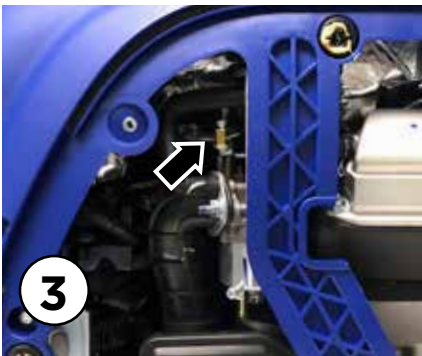

5. To adjust the cable place the control knob into the RUN position

6. Loosen the screw at the top of the cable clamp.

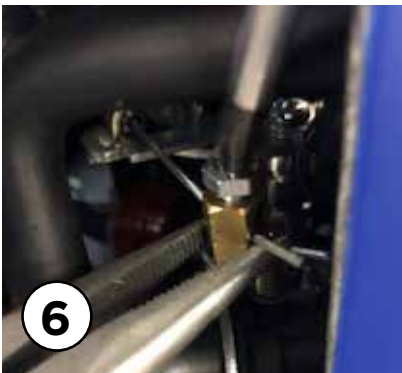

7. Using pliers, pull more slack in the cable so that when you switch from RUN to OFF the choke cable does not move.



8. Rotate the control knob from CHOKE to RUN to confirm the choke is fully open.

9. Tighten the screw on the cable and start the inverter. If the issue still persists you may need to change the slack in the cable and test again.